

Cleanview Passive

1994F

No Power

- 1) Plug machine into a functioning outlet and try to turn on.
- 2) If machine does not turn on, unplug machine and test a different device (ex: phone charger) in the same outlet.
- 3) If outlet doesn't work for different device, test the machine in a different outlet.
- 4) If the machine still won't turn on, unplug the machine and run palm along entire length of cord. The cord should be smooth and have no punctures or tears.
- 5) Also inspect outlet prongs on plug for damage. If damage is found on cord or plug, see step 7
- 6) Is the amp limit on their circuit breaker exceeded?
 - Inform them most homes are set up in zones with several outlets attached each one circuit breaker.

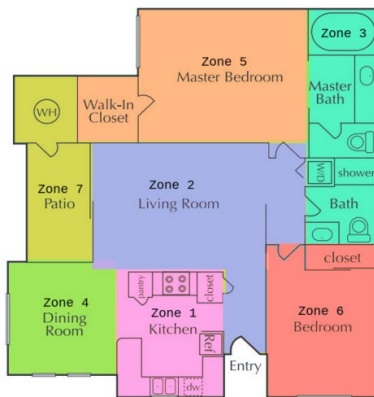

Example shows that all the outlets in each room are

- in an individual zone
 - on a single breaker
- Also, all outlets in both bathrooms are on 1 breaker

This example shows 7 zones attached to 7 different circuit breakers in a house. Each room has several outlets.

- If the total power plugged into those outlets exceeds the breaker when this unit is turned on, it may be tripping the breaker. They may need to find a different outlet in a different zone, or safely unplug/turn off another appliance on that same zone.

7) If the unit still won't turn on,

BISSELL Consumer Care: please refer to product changeover guide.

External Support: Contact BISSELL