

Stain Eraser™ Pet has No Spray | Support

If you are experiencing spray issues, follow these steps to resolve:

Make sure battery is fully charged

- A fully charged battery will have 3 white lights when turned on
 - Is battery fully charged?
 - No > Charge for 4.5 hours
 - Yes > Continue below

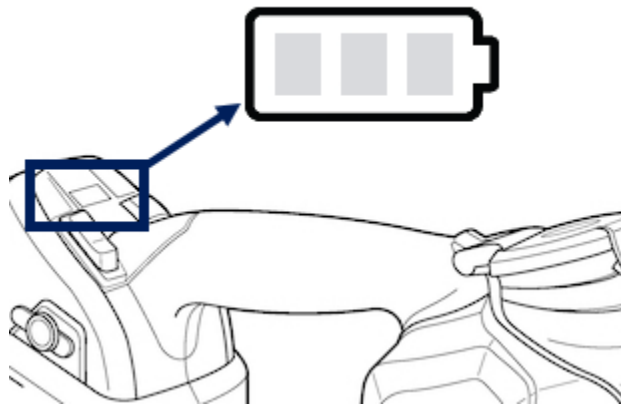

Ensure formula is in machine

- Flip lid on formula tank & add formula to fill line

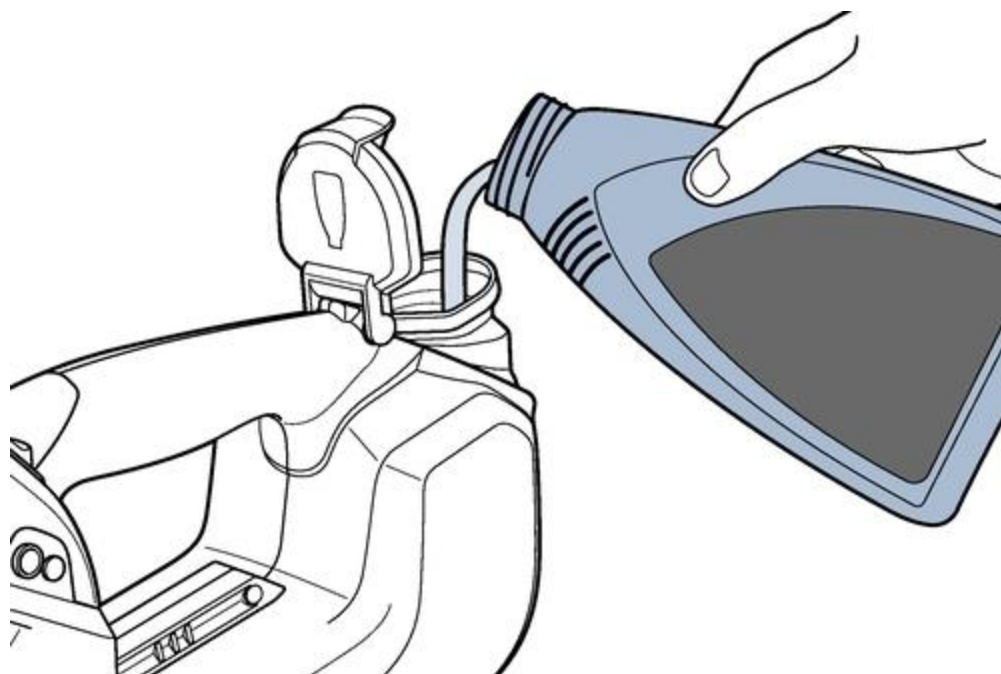

Check spray tip for buildup

- Wipe spray tip with damp cloth to remove any blockages

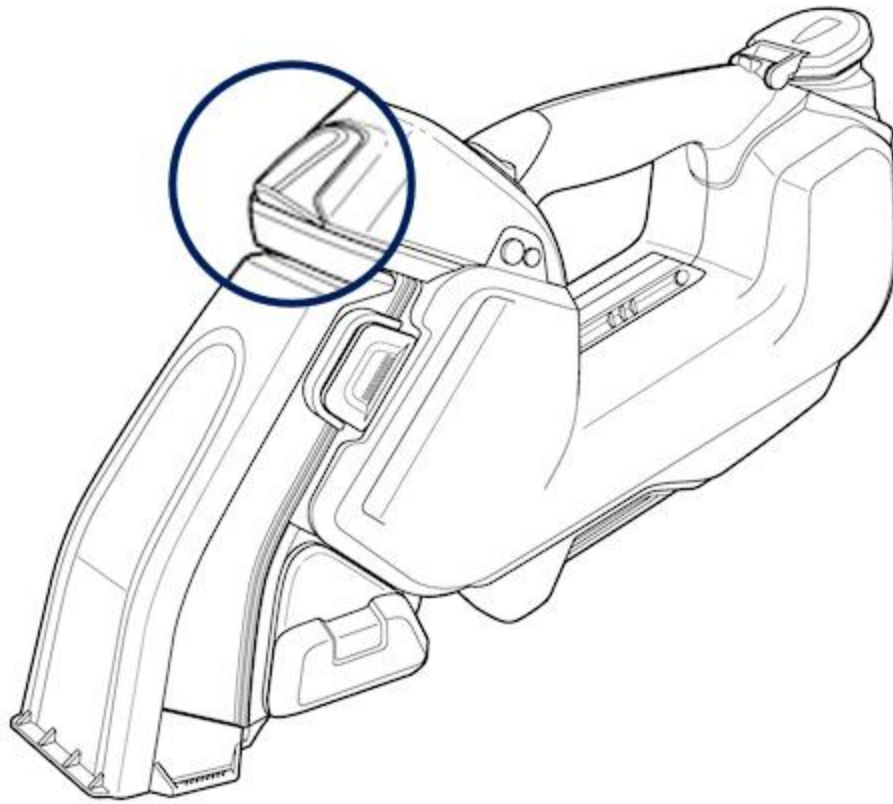

Test machine

- Turn machine on
- Press spray button & gently rock machine back & forth
 - Note: Ensure machine is horizontal for best spray performance

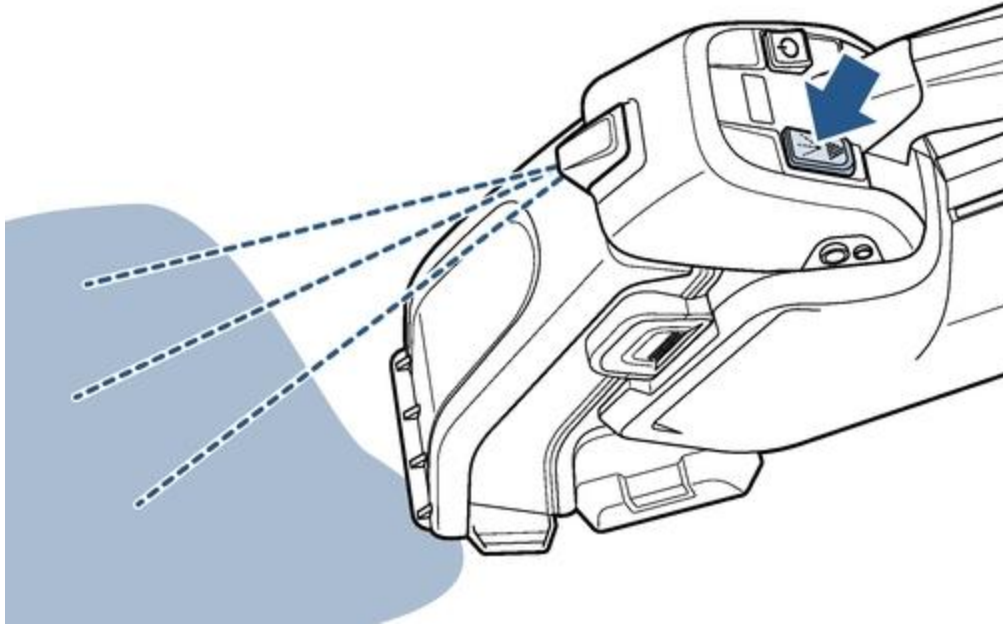

Did this resolve your issue?

- If you still need assistance > [**Contact Us**](#)