

# CLEANVIEW<sup>®</sup> Canister Vacuum

---

USER GUIDE  
1994 SERIES

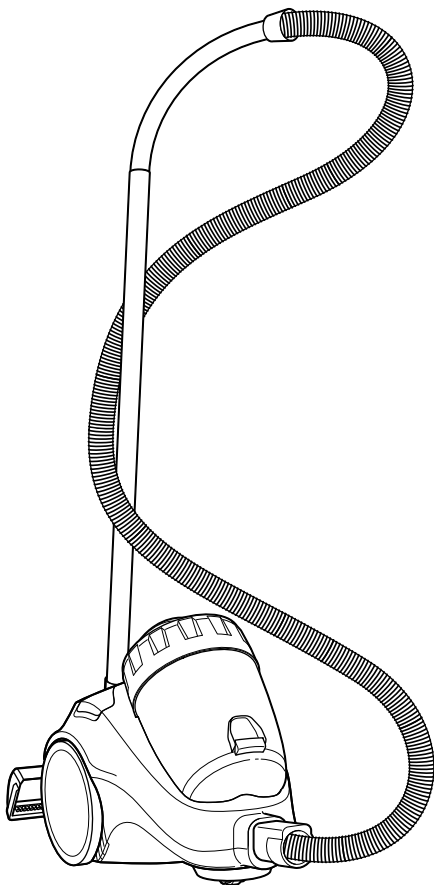

# IMPORTANT SAFETY INSTRUCTIONS

## READ ALL INSTRUCTIONS BEFORE USING YOUR APPLIANCE.

Unplug from outlet when not in use and before conducting maintenance. When using an electrical appliance, basic precautions should be observed, including the following:

### **WARNING**

#### **TO REDUCE THE RISK OF FIRE, ELECTRIC SHOCK, OR INJURY:**

- » This appliance can be used by children aged from 8 years and above and persons with reduced physical, sensory or mental capabilities or lack of experience and knowledge if they have been given supervision or instruction concerning use of the appliance in a safe way and understand the hazards involved. Cleaning and user maintenance shall not be made by children without supervision.
- » Children should be supervised to ensure that they do not play with the appliance.
- » Keep hair, loose clothing, fingers, and all parts of body away from openings and moving parts of the appliance and its accessories.
- » Unplug from electrical socket when not in use, before cleaning, maintaining or servicing the appliance, and if your appliance has an accessory tool with a moving brush, before connecting or disconnecting the tool.
- » If the supply cable is damaged, it must be replaced by the manufacturer, its service agent, or similarly qualified person in order to avoid a hazard.
- » Do not run appliance over cable.
- » Do not leave appliance when plugged in.
- » Do not use with damaged cable or plug.
- » Do not pull or carry by cable, use cable as a handle, close door on cable, or pull cable around sharp edges or corners.
- » Keep cable away from heated surfaces.
- » To unplug, grasp the plug, not the cable.
- » Do not handle plug or appliance with wet hands.
- » Turn off all controls before unplugging.
- » Hold plug when rewinding onto cord reel. Do not allow plug to whip when rewinding.
- » Plastic film can be dangerous. To avoid danger of suffocation, keep away from children.
- » Use only as described in this user guide.
- » Use only manufacturer's recommended attachments.
- » Do not immerse in water or liquid.
- » If appliance is not working as it should, has been dropped, damaged, left outdoors, or dropped into water; do not attempt to operate it and have it repaired at an authorized service center.
- » Do not put any object into openings.
- » Do not use with any opening blocked; keep free of dust, lint, hair, and anything that may reduce air flow.
- » Use extra care when cleaning on stairs.
- » Do not use to pick up flammable or combustible liquids, such as petroleum, or use in areas where they may be present.
- » Do not pick up toxic material (chlorine bleach, ammonia, drain cleaner, etc.)
- » Do not use appliance in an enclosed space filled with vapours given off by oil base paint, paint thinner, some mothproofing substances, flammable dust, or other explosive or toxic vapours.
- » Do not pick up hard or sharp objects such as glass, nails, screws, coins, etc.
- » Keep appliance on a level surface.
- » Do not pick up anything that is burning or smoking, such as cigarettes, matches, or hot ashes.
- » If your appliance has a motorized brushroll, do not leave machine running in the same spot without the handle fully upright.
- » Do not use outdoors or on wet surfaces.
- » This appliance is provided with double insulation. Use only identical replacement parts.
- » Do not use to suck up water.
- » Do not immerse in water for cleaning.
- » The hose should be checked regularly and must not be used if damaged.
- » The hose contains electrical wires. Do not use when damaged, cut, or punctured. Avoid picking up sharp objects.
- » Always turn off this appliance before connecting or disconnecting either hose or motorized nozzle.

### **WARNING**

**HOSE CONTAINS ELECTRICAL CONNECTIONS.**

## SAVE THESE INSTRUCTIONS

**FOR OPERATION ON A 220-240 VOLT A.C. 50-60 HZ POWER SUPPLY ONLY.**

This model is for household use only.

# Thanks for buying a BISSELL vacuum!

We love to clean and we're excited to share one of our innovative products with you. We want to make sure your vacuum works as well in two years as it does today, so this guide has tips on using (pages 7-8), maintaining (pages 9-10), and if there is a problem, troubleshooting (page 11).

In just a few simple assembly steps, you'll be ready to vacuum. Flip to page 5 and let's get started!

## What's In The Box?

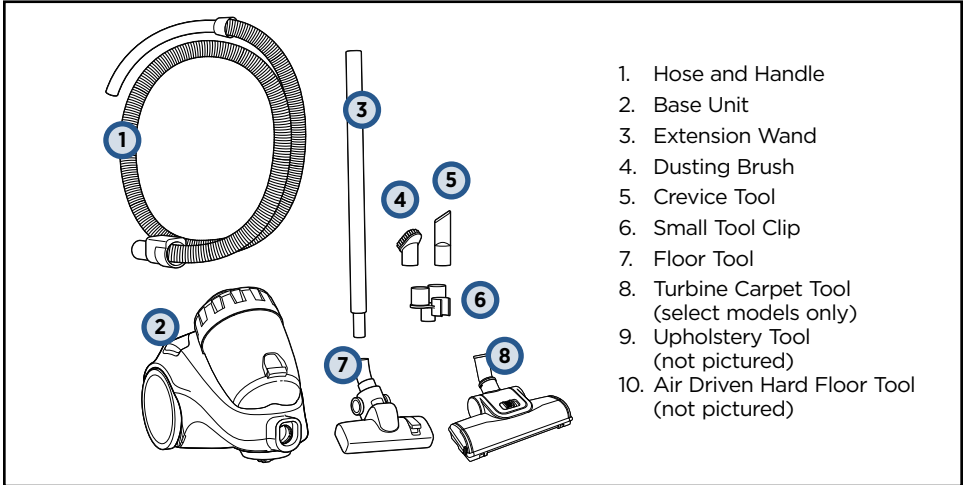

1. Hose and Handle
2. Base Unit
3. Extension Wand
4. Dusting Brush
5. Crevice Tool
6. Small Tool Clip
7. Floor Tool
8. Turbine Carpet Tool (select models only)
9. Upholstery Tool (not pictured)
10. Air Driven Hard Floor Tool (not pictured)

**NOTE:** Standard accessories may vary by model. To identify what should be included with your purchase, please refer to the "Carton Contents" list located on the carton top flap.

Safety Instructions.....2

Product View.....4

Assembly .....5-6

Operations .....7-8

Maintenance & Care .....9-10

Troubleshooting .....11

Warranty.....12

Service.....12

# Product View

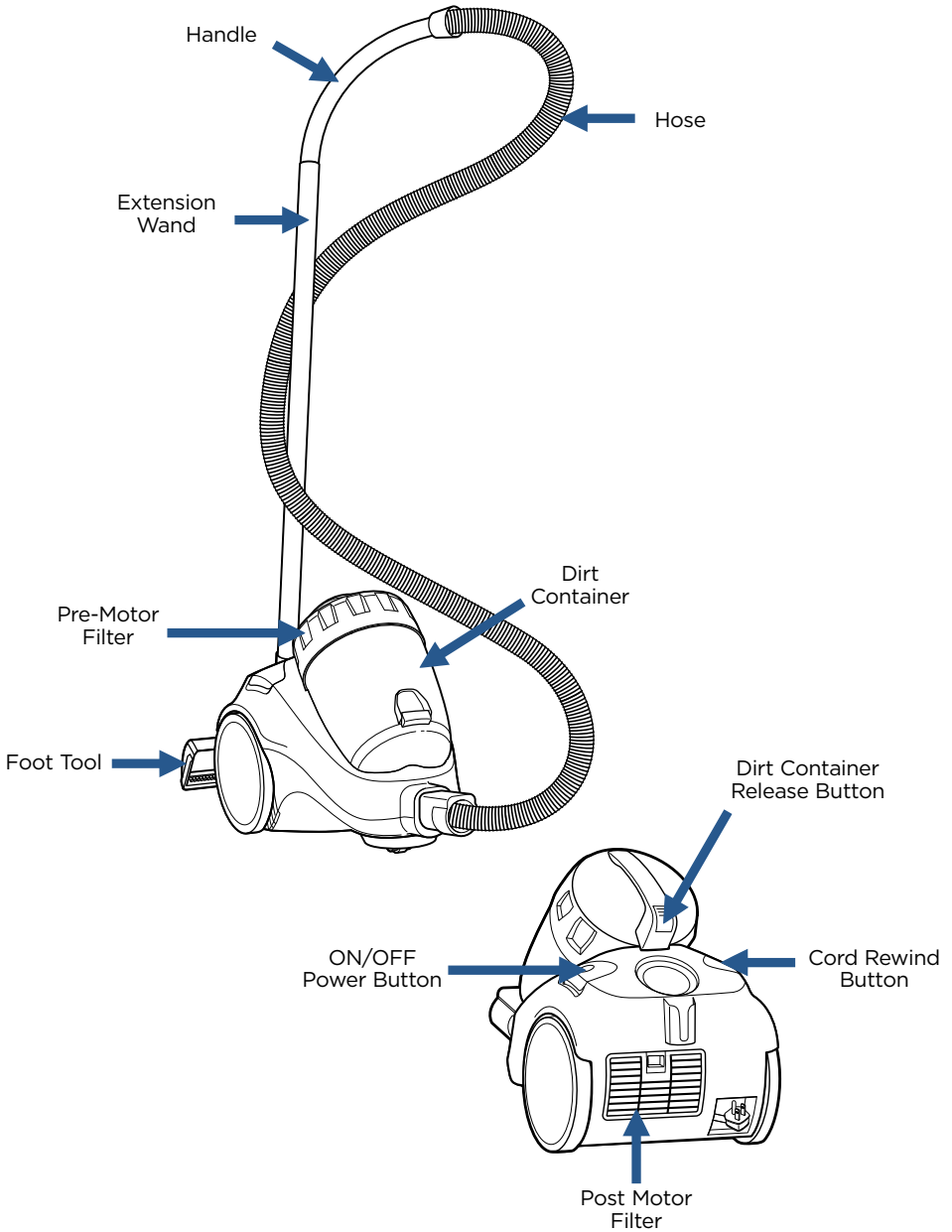

# Assembly

## **⚠️ WARNING**

Do not plug in your vacuum until you are familiar with all instructions and operating procedures.

1

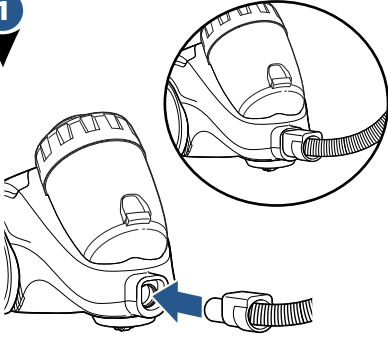

Push hose connector into body until you hear a "click."

2

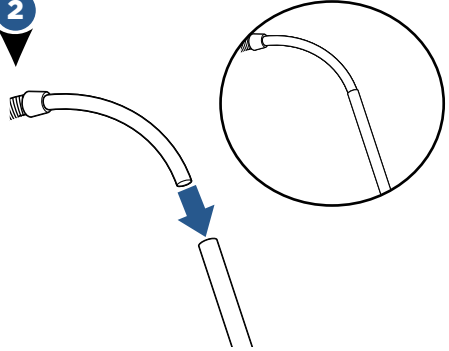

Push handle end into top of extension wand until secure.

3

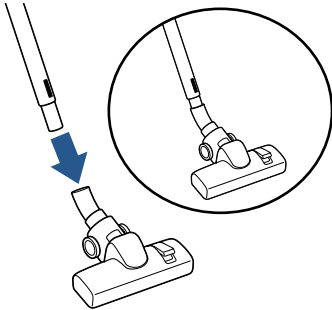

Push bottom of extension wand into floor tool until secure.

4

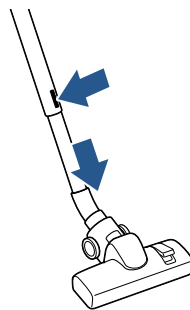

Press wand extension button and pull wand to extend.

5

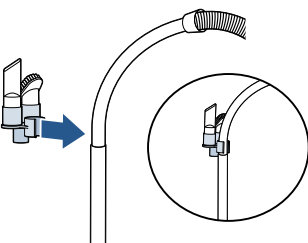

Accessory clip can be attached to the handle for storage.

6

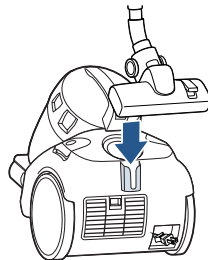

The floor tool can be parked on the rear of the unit for storage.

# Assembly of Turbine Carpet and Air Driven Floor Tools (select models only)

## **WARNING**

Do not plug in your vacuum until you are familiar with all instructions and operating procedures.

1

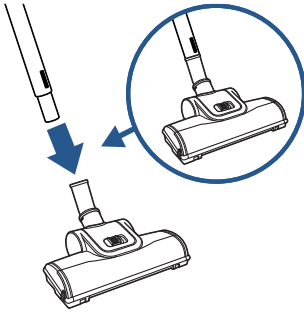

Push bottom of extension wand into the tool until secure.

2

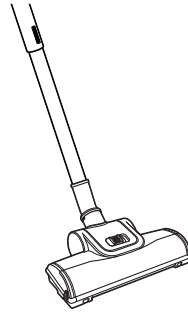

Press wand extension button and pull wand to extend.

3

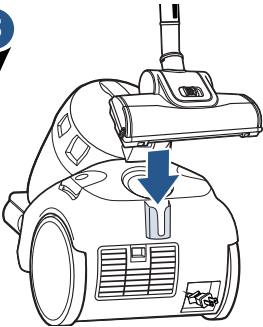

The floor tool can be parked on the rear of the unit for storage.

# Operating The Product

## **WARNING**

Before using your vacuum, make sure that the dirt container is in locked position and that all filters, both pre and post-filters are in place. **DO NOT** operate your vacuum without these filters.

1

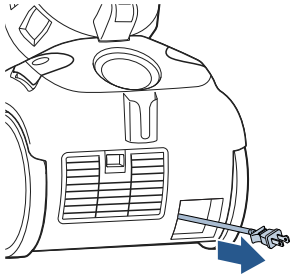

Pull the cord out and plug into socket.

2

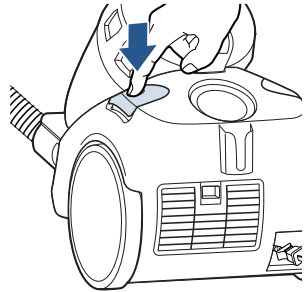

Press on-off button to turn on vacuum.

3

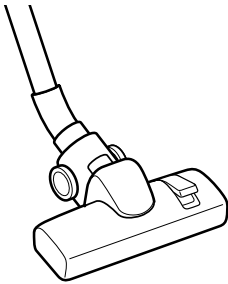

Floor tool can be used on carpeted and hard floor surfaces. Use on hard floor with the pedal in 'up' position to lower brush bar.

4

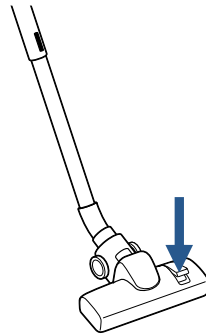

For carpeted floor press the pedal down to retract the brush bar.

**NOTE:** Some frieze carpets have long delicate fibers or threads that may be damaged by rotating brush. Turn off the PowerBrush when cleaning this and other similar types of carpet.

# Above Floor Cleaning

1

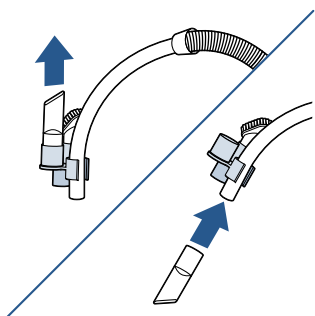

Remove crevice tool from clip and push onto handle end until secure. Use crevice tool to clean in narrow spaces.

2

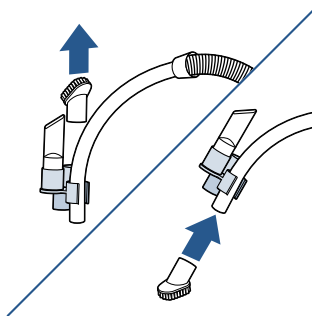

Remove dusting brush from clip and push onto handle end until secure. Use dusting brush to clean multiple off-floor surfaces.

3

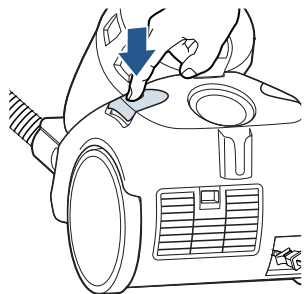

Press on-off button to turn vacuum off.

4

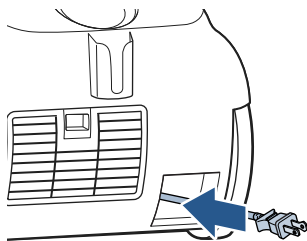

Unplug from wall socket and retract cable by pressing cord rewind button.

## Parts & Supplies

For Parts and Supplies, go to [www.BISSELL.com](http://www.BISSELL.com) and enter your model number in the search field.



# Maintenance: Empty the Dirt Container

## **⚠️ WARNING**

To reduce the risk of electrical shock, turn power switch off and disconnect polarized plug from electrical outlet before performing maintenance or troubleshooting checks.

1

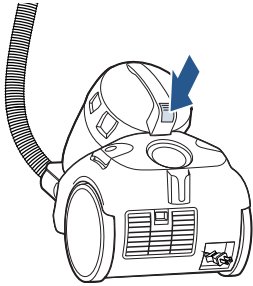

Press dirt container release button.

2

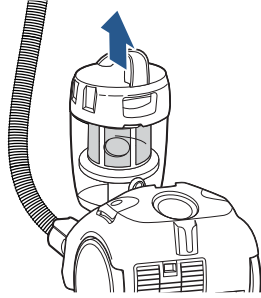

Pull dirt container away from vacuum body by the handle.

3

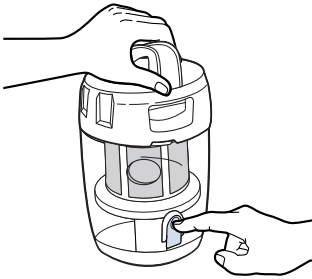

Hold the dirt container over a trash can and press the release button on back.

4

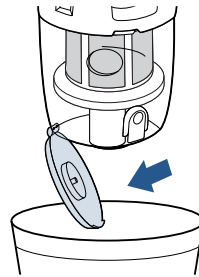

Once the dirt container is emptied, snap everything back in place.

# Cleaning the Filters

## **⚠**WARNING

Do not operate vacuum with damp or wet filters, as well as without filters or the Dirt Container in place. Allow components to dry before reassembling the Dirt Container.

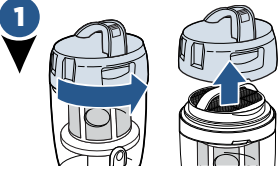

With dirt tank removed, twist its top counter-clockwise and pull up.

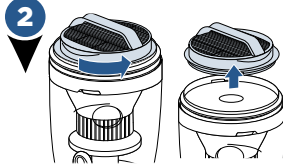

Grab the pre-motor filter assembly and turn it counter clockwise, pulling up to remove.

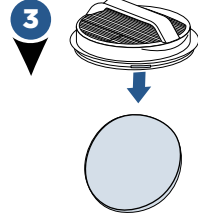

Separate foam and pleated filters.

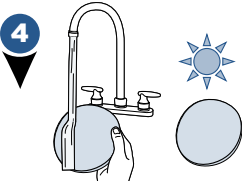

Foam filter can be rinsed to clean. Leave to dry for 24 hours before reassembling.

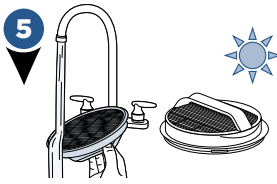

Pleated filter can be rinsed to clean. Leave to dry for 24 hours before reassembling.

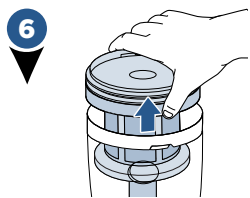

Cyclone system can be easily pulled out of the dirt container.

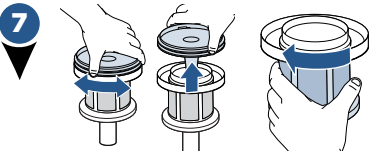

Disassemble the cyclone system by simply twisting counter-clockwise to separate in to three parts; the black primary cyclone on top, mesh filter frame, and the primary separator beneath the mesh filter frame.

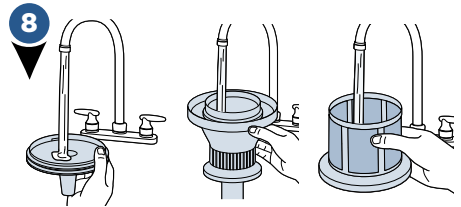

The cyclone system can be rinsed to clean. Leave to dry for 24 hours before reassembling.

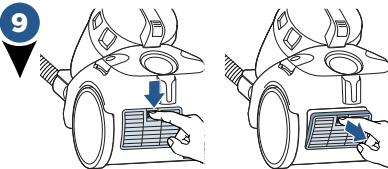

To access the post motor filter, press the release button on the back of the vacuum and pull the filter door away.

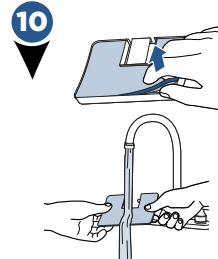

The post motor filter can be removed from filter door before cleaning. Rinse under tap to clean and allow to dry for 24 hours before reassembling.

# Troubleshooting

## **WARNING**

To reduce the risk of electric shock, turn power switch off and disconnect plug from electrical outlet before performing maintenance or troubleshooting checks.

<b>Problem</b>	<b>Possible causes</b>	<b>Remedies</b>
<b>Vacuum won't pick up dirt</b>	Filters are dirty	Remove and rinse pre-motor and post-motor filters. Allow enough time for them to dry properly before reinserting
	The Main Hose is not connected	Locate the Main Hose and reconnect by pushing the hose connection to secure the latch
	There is a crack or hole in the Main Hose	If there is a crack or hole, order a new Main Hose from the BISSELL website
	There is a clog in the vacuum	Remove debris and any other entanglements that may be restricting its rotation
	The Dirt Container is not seated correctly	Press the Empty Button to release the Dirt Container and reseal properly
<b>Dirt is escaping from the vacuum</b>	The Dirt Container is full	Empty the Dirt Container
	Filters are missing	Check to see if all of the Pre-Motor and Post-Motor filters are in place
	The Dirt Container is not seated properly	Press the Empty Button and remove the Dirt Container. Insert the bottom first and pivot the Dirt Container towards the vacuum. Listen for a "click" sound, indicating that it snapped into place

# Consumer Guarantee

This guarantee gives you specific legal rights, in addition to rights you may have under the Australian consumer law. If you need additional instruction regarding this guarantee or have questions regarding what it may cover, please contact your local BISSELL consumer services on the details set out below.

## Limited 2 Year Guarantee from the date of purchase by original purchaser

Subject to the \*conditions identified below, BISSELL will repair or replace (with new or remanufactured components or products), at BISSELL's option, free of charge, any defective or malfunctioning part due to manufacturer defect. This guarantee applies to product used for personal purposes, and not commercial or rental service. This guarantee does not apply to fans or routine maintenance or consumable components such as filters, belts, brush rolls, etc., damage or malfunction caused by negligence, abuse, neglect, unauthorized repair, or any other use not in accordance with the user's guide. BISSELL recommends that the original packaging be kept for the duration of the guarantee period in case such need arises within the guarantee period that the item needs re-packing and transportation.

### \*CONDITIONS OF GUARANTEE

Subject to whether such loss is reasonably foreseeable, BISSELL and its in-country distributors are not liable for incidental or consequential damages of any nature associated with the use of this product.

### FOR AUSTRALIAN CONSUMERS ONLY:

OUR GOODS COME WITH GUARANTEES THAT CANNOT BE EXCLUDED UNDER THE AUSTRALIAN CONSUMER LAW. YOU ARE ENTITLED TO A REPLACEMENT OR REFUND FOR A MAJOR FAILURE AND FOR COMPENSATION FOR ANY OTHER REASONABLY FORESEEABLE LOSS OR DAMAGE. YOU ARE ALSO ENTITLED TO HAVE THE GOODS REPAIRED OR REPLACED IF THE GOODS FAIL TO BE OF ACCEPTABLE QUALITY AND THE FAILURE DOES NOT AMOUNT TO A MAJOR FAILURE.

THIS GUARANTEE IS IN ADDITION TO OTHER RIGHTS OR REMEDIES UNDER LAW. NOTHING IN THIS GUARANTEE EXCLUDES, LIMITS OR MODIFIES ANY LIABILITY OF BISSELL WHICH IS IMPOSED BY LAW, OR LIMITS OR MODIFIES ANY REMEDY AVAILABLE TO THE CONSUMER WHICH IS GRANTED BY LAW. TO MAKE A CLAIM UNDER THIS GUARANTEE CONTACT BISSELL AUSTRALIA PTY LTD (DETAILS ABOVE). CONTACT BISSELL PRIOR TO RETURNING ANY GOODS. WHERE AGREED, BISSELL WILL REIMBURSE REASONABLE POSTAGE / HANDLING COSTS (IF ANY) FOR RETURNING GOODS TO BISSELL. TO CLAIM EXPENSES INCURRED IN MAKING A CLAIM UNDER THIS GUARANTEE PLEASE PROVIDE BISSELL WITH A COPY OF THE RECEIPT OF THE EXPENSES BY EMAIL OR POST.

## Consumer Care

If your BISSELL product should require service or to claim under our limited guarantee, please contact us as follows:

### Website:

[www.BISSELL.com](http://www.BISSELL.com)

### Email:

[consumercare@bissell.com](mailto:consumercare@bissell.com)

### Write:

BISSELL AUSTRALIA PTY LIMITED  
42 Rocco Dr.  
Scoresby 3179  
Victoria  
Australia

### Telephone:

Australia: 1300-247-735  
New Zealand: 0800-247-735

Replacement parts and accessories are available for purchase. To purchase visit [www.BISSELL.com.au](http://www.BISSELL.com.au)

## Visit the BISSELL website: [www.BISSELL.com.au](http://www.BISSELL.com.au)

When contacting BISSELL, have model number of cleaner available.

Please record your Model Number: \_\_\_\_\_ Please record your Purchase Date: \_\_\_\_\_

**NOTE: Please keep your original sales receipt. It provides proof of the date of purchase in the event of a Guarantee claim. See Guarantee for details.**



©2017 BISSELL Homecare, Inc  
Grand Rapids, Michigan  
All rights reserved. Printed in China  
Part Number 161-3558 08/17  
Visit our website at: [www.BISSELL.com](http://www.BISSELL.com)